



Demi HSA Filter Housing

- sanitary air / gas

- Flow efficient sanitary range of air / gas housings
- Designed specifically for the food and beverage industry
- Sanitary tri-clamp, vent and drain connections as standard
- Sanitary tri-clamp body closure as standard



Specification

Materials of Construction

- Housing: 316L Stainless Steel
- Seals: Silicone FDA

Surface Finish

- Internal: Polished 0.4 µm Ra
- External: Polished 0.25 µm Ra

All finishes pickled & passivated.

Welding

All assembly welds are full penetration. All welds are crevice and undercut free.

Weld finish & detail drawings available upon request.

Certification

Supplied as standard with vessel inspection certificate.

Material Test Certification

EN10204 3.1 supplied upon request.

Design Code

Housings designed in accordance with the European Council Pressure Equipment Directive (PED) 97/23/EC and the UK Statutory Pressure Equipment Regulations (PER) 1999 N° 2001.

Design Basis

ASME VIII Division 1.

Working Condition PED 97/23/EC			Maximum Pressure	
Fluid Group	State	Temperature	01A	01B
Non Dangerous & Dangerous	Gas / Vapour	150 °C (302 °F)	10.00 barg (145.03 psig)	10.00 barg (145.03 psig)
PED Conformity Assessment Category			SEP	SEP
Volume (litres)			0.75	0.50

Physical Characteristics

Bowl Height	Dimensions (mm)			Typical Weight (Kg)
	'A'	'B'	'C'	
A Size 5" (125 mm)	152	227	130	1.3
B Size 2 1/2" (65 mm)	152	172	70	1.2

Dimensions are based on illustration shown (HSACE01ABT-T-S). For accurate dimensions, please contact Parker domnick hunter.

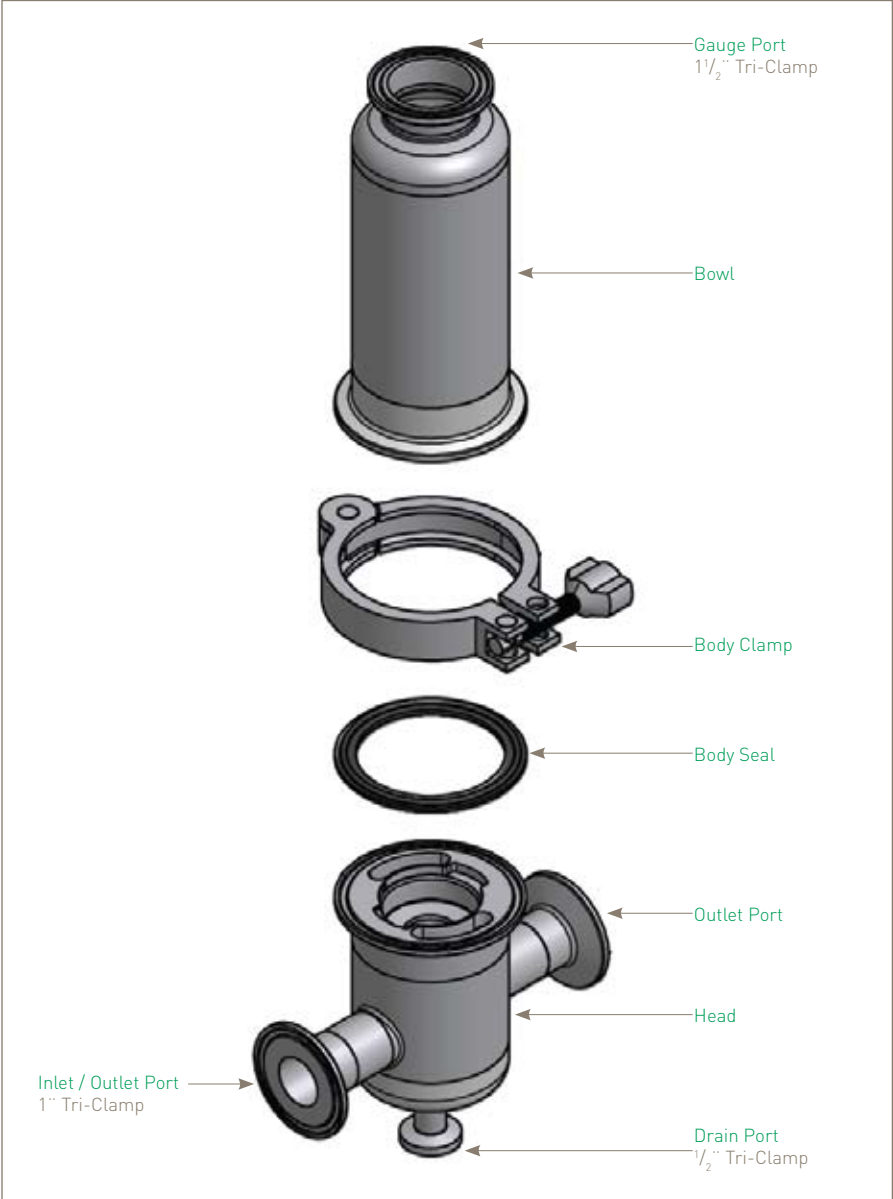
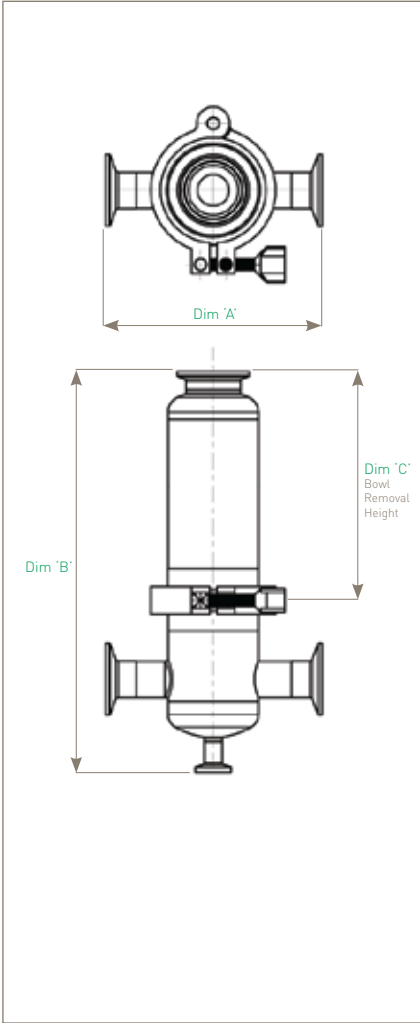

Ordering Information

HSA	<input type="text"/>	01	<input type="text"/>	<input type="text"/>	-	<input type="text"/>	-	<input type="text"/>
Code Vessel Class	Code Length (Nominal)	Code Connection Size	Code Standard	Code Cartridge	Code Seal			
CE Standard	A 5" (125 mm) B 2 1/2" (65 mm)	B 1"	T Tri-Clamp	T 126	S Silicone			

Note: For accessories, i.e. gauges, please contact Parker domnick hunter - Process Division for full availability.

For additional features, Parker domnick hunter offer this housing as part of its Standard PLUS Range. Please see HSA® datasheet for more information.

Parker domnick hunter has a continuous policy of product development and although the Company reserves the right to change specifications, it attempts to keep customers informed of any alterations. This publication is for general information only and customers are requested to contact our Process Filtration Sales Department for detailed information and advice on a products suitability for specific applications. All products are sold subject to the company's Standard conditions of sale.



Demi HBA Filter Housing

- industrial and beverage air / gas

- Flow efficient range of air / gas housings
- Designed to maximise flow and minimise pressure drop
- Designed specifically for the food and beverage industry



Specification

Materials of Construction

- Housing: 316L Stainless Steel
- Body Seal: Silicone FDA
- Vent / Drain Seal: PTFE FDA

Surface Finish

- Internal: Unpolished 1 µm Ra Typical
 - External: Polished 0.8 µm Ra
- All finishes pickled & passivated.*

Welding

All assembly welds are full penetration.
All welds are crevice and undercut free.
Weld finish & detail drawings available upon request.

Certification

Supplied as standard with vessel inspection certificate.

Material Test Certification

EN10204 3.1 supplied upon request.

Design Code

Housings designed in accordance with the European Council Pressure Equipment Directive (PED) 97/23/EC and the UK Statutory Pressure Equipment Regulations (PER) 1999 N° 2001.

Design Basis

ASME VIII Division 1.

Working Condition PED 97/23/EC			Maximum Pressure	
Fluid Group	State	Temperature	01A	01B
Non Dangerous & Dangerous	Gas / Vapour	150 °C (302 °F)	10.00 barg (145.03 psig)	10.00 barg (145.03 psig)
PED Conformity Assessment Category			SEP	SEP
Volume (litres)			0.75	0.50

Physical Characteristics

Bowl Height	Dimensions (mm)			Typical Weight (Kg)
	'A'	'B'	'C'	
A Size 5" (125 mm)	175	300	130	1.5
B Size 2 1/2" (65 mm)	175	245	70	1.4

Dimensions are based on illustration shown (HBACE01ABB-TS).
For accurate dimensions, please contact Parker domnick hunter.

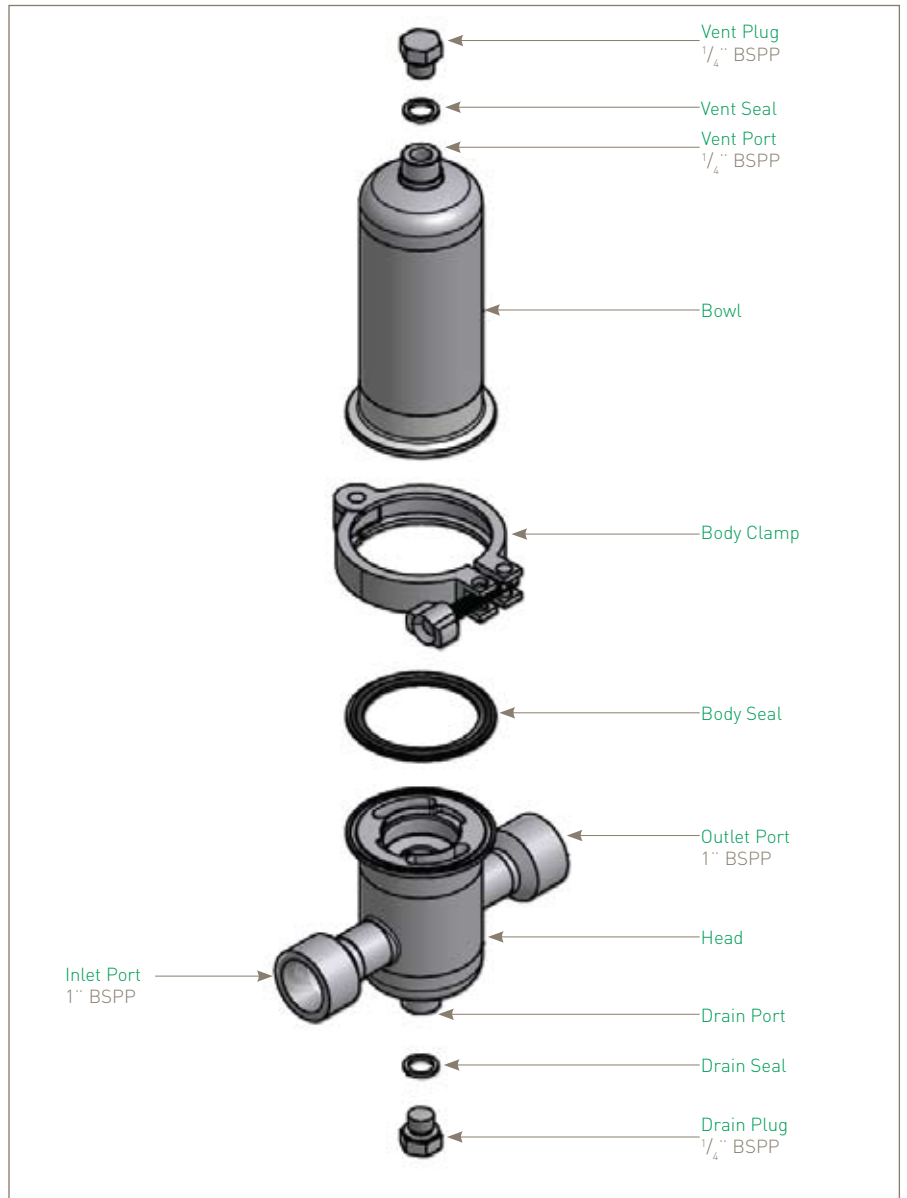
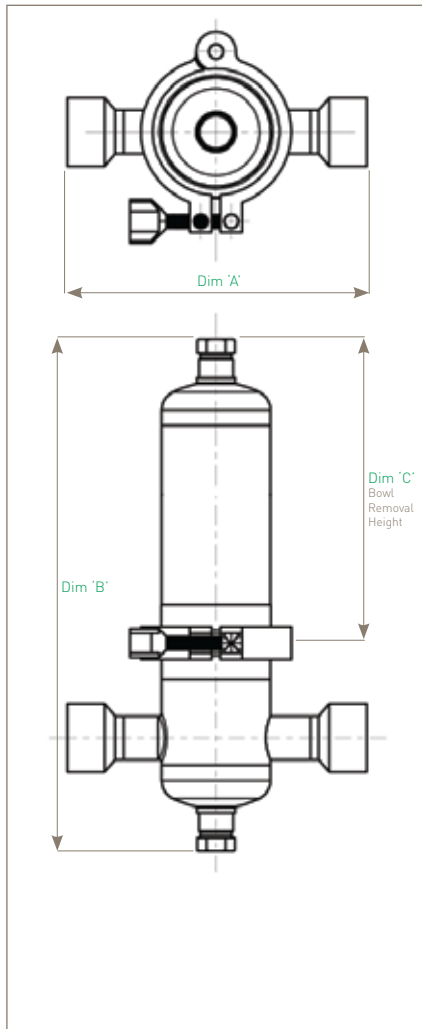

Ordering Information

HBA	<input type="text"/>	01	<input type="text"/>	<input type="text"/>	<input type="text"/>	-	<input type="text"/>	-	<input type="text"/>
Code Vessel Class	Code Length (Nominal)	Code Connection Size	Code Standard	Code Cartridge	Code Seal				
CE Standard	A 5" (125 mm) B 2 1/2" (65 mm)	B 1"	B BSPP N NPT	T 126	S Silicone				

Note: For accessories, i.e. gauges, please contact Parker domnick hunter - Process Division for full availability.

For additional features, Parker domnick hunter offer this housing as part of its Standard PLUS Range.
Please see HBA® datasheet for more information.

Parker domnick hunter has a continuous policy of product development and although the Company reserves the right to change specifications, it attempts to keep customers informed of any alterations. This publication is for general information only and customers are requested to contact our Process Filtration Sales Department for detailed information and advice on a products suitability for specific applications. All products are sold subject to the company's Standard conditions of sale.



Demi HSV Filter Housing

- vent housing

- Direct connection to tank boss allows housing to be self-supportive
- Corrosion resistant 316L stainless steel
- Easy assembly and maintenance



Specification

Materials of Construction

- Housing: 316L Stainless Steel
- Seals: Silicone FDA

Surface Finish

- Internal: Polished 0.8 µm Ra
- External: As welded

All finishes pickled & passivated.

Welding

All assembly welds are full penetration. All welds are crevice and undercut free.

Weld finish & detail drawings available upon request.

Certification

Supplied as standard with vessel inspection certificate.

Material Test Certification

EN10204 3.1 supplied upon request.

Working Condition PED 97/23/EC		Volume (litres)	
State	Temperature	01A	01B
Gas / Vapour	150 °C (302 °F)	0.75	0.50

Recommended Operation Guidelines Sizing

Sizing vent vessels particularly for vacuum sensitive tanks can require specialist advice. It is important that VENT housings are sized on maximum gas flow capacity under actual operation conditions.

Vacuum Protection

Where a tank is vacuum sensitive, there is a risk of tank collapse. In such cases the fitting of an appropriately rated bursting disc (or similar) and, if necessary a pressure relief valve, is highly recommended.

Physical Characteristics

Bowl Height	Dimensions (mm)		Typical Weight (Kg)
	'B'	'C'	
A Size 5" (125 mm)	195	130	1.0
B Size 2 1/2" (65 mm)	140	70	0.9

Dimensions are based on illustration shown [HSVDH01ABT-T-S].
For accurate dimensions, please contact Parker domnick hunter.

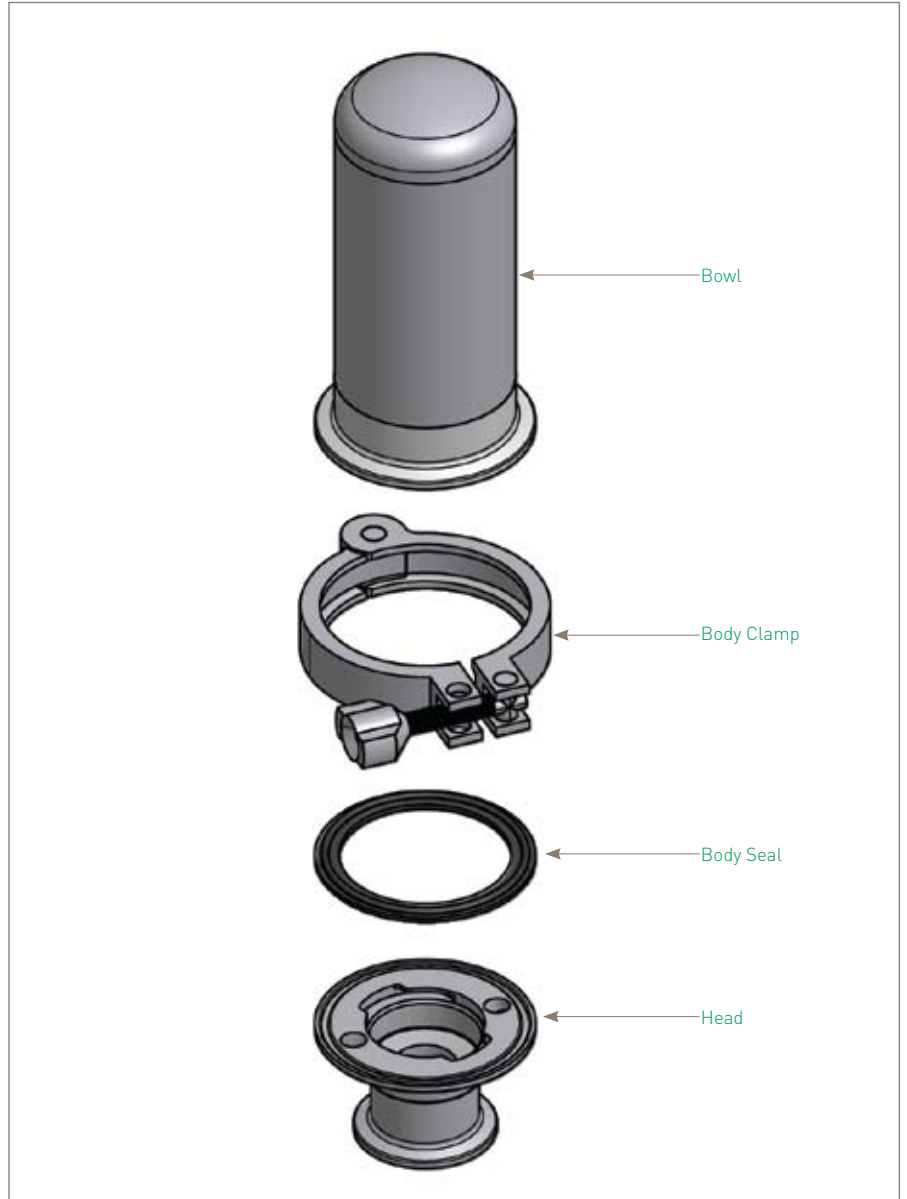
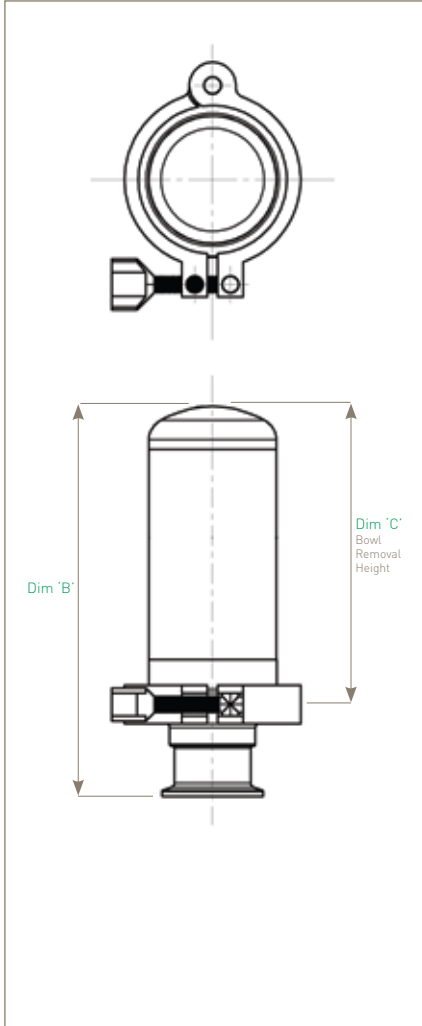

Ordering Information

Code Vessel Class	Code Length (Nominal)	Code Connection Size	Code Standard	Code Cartridge	Code Seal
DH Vent Housing	A 5" (125 mm) B 2 1/2" (65 mm)	B 1"	T Tri-Clamp	T 126	S Silicone

Note: For accessories, i.e. gauges, please contact Parker domnick hunter - Process Division for full availability.

For additional features, Parker domnick hunter offer this housing as part of its Standard PLUS Range.
Please see HSV® datasheet for more information.

Parker domnick hunter has a continuous policy of product development and although the Company reserves the right to change specifications, it attempts to keep customers informed of any alterations. This publication is for general information only and customers are requested to contact our Process Filtration Sales Department for detailed information and advice on a products suitability for specific applications. All products are sold subject to the company's Standard conditions of sale.



Demi HSL Filter Housing

- sanitary liquid

- Single element sanitary liquid housing
- Sanitary tri-clamp, vent and drain connections as standard
- Sanitary tri-clamp body closure as standard



Specification

Materials of Construction

- Housing: 316L Stainless Steel
- Seals: Silicone FDA

Surface Finish

- Internal: Polished 0.4 µm Ra
- External: Polished 0.25 µm Ra

All finishes pickled & passivated.

Welding

All assembly welds are full penetration. All welds are crevice and undercut free.

Weld finish & detail drawings available upon request.

Certification

Supplied as standard with vessel inspection certificate.

Material Test Certification

EN10204 3.1 supplied upon request.

Design Code

Housings designed in accordance with the European Council Pressure Equipment Directive (PED) 97/23/EC and the UK Statutory Pressure Equipment Regulations (PER) 1999 N° 2001.

Design Basis

ASME VIII Division 1.

Working Condition PED 97/23/EC			Maximum Pressure	
Fluid Group	State	Temperature	01A	01B
Non Dangerous & Dangerous	Gas / Vapour & Liquid	150 °C (302 °F)	10.00 barg (145.03 psig)	10.00 barg (145.03 psig)
PED Conformity Assessment Category			SEP	SEP
Volume (litres)			0.75	0.50

Physical Characteristics

Bowl Height	Dimensions (mm)			Typical Weight (Kg)
	'A'	'B'	'C'	
A Size 5" (125 mm)	117	191	130	2.0
B Size 2 1/2" (65 mm)	117	136	70	1.8

Dimensions are based on illustration shown (HSLCE01ABT-T-S).
For accurate dimensions, please contact Parker domnick hunter.

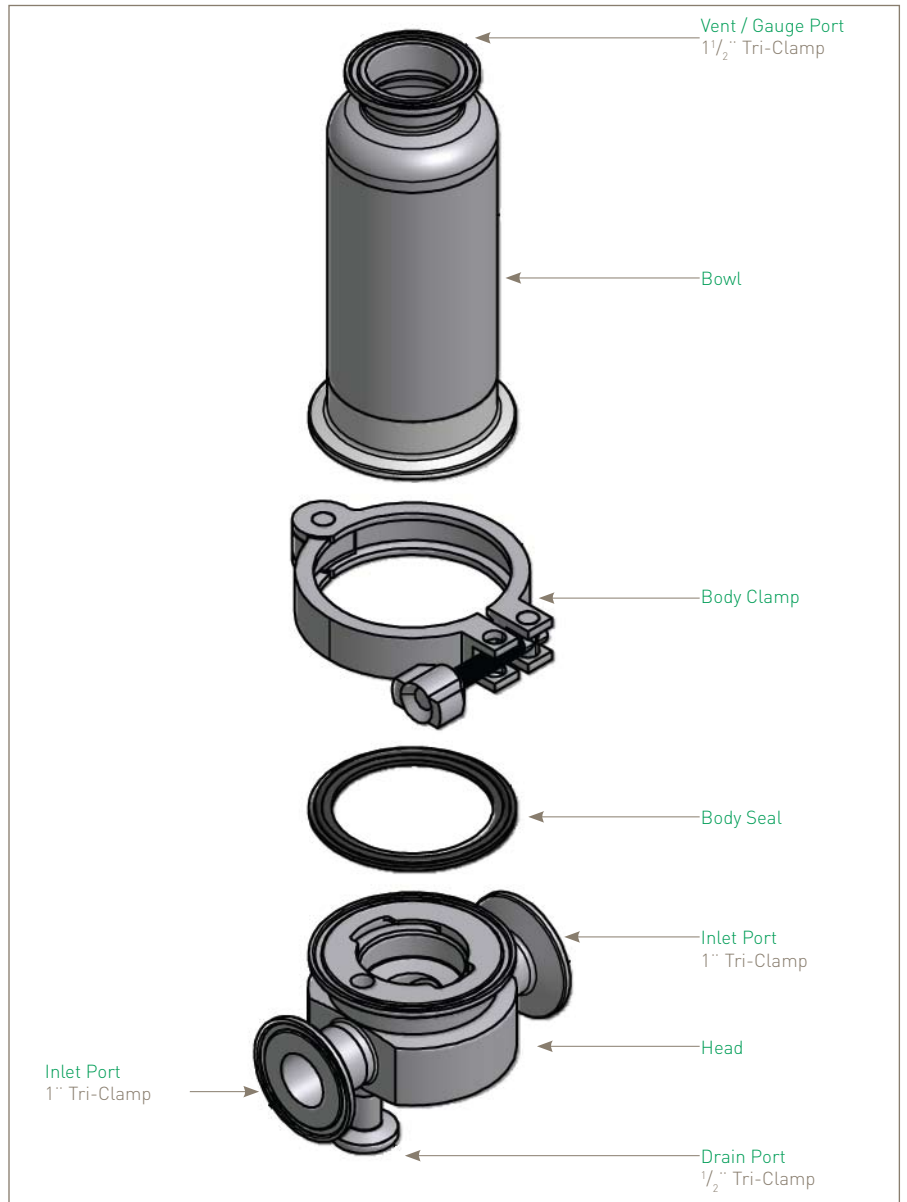
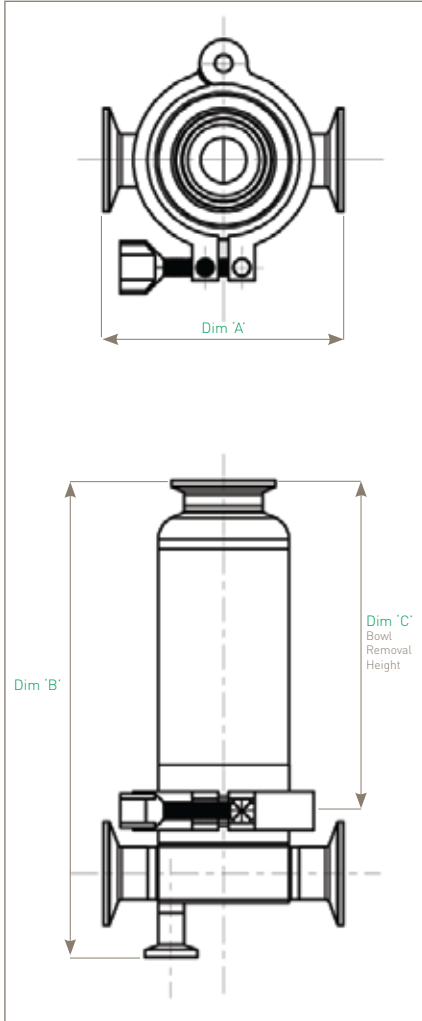

Ordering Information

HSL	<input type="checkbox"/>	01	<input type="checkbox"/>	<input type="checkbox"/>	-	<input type="checkbox"/>	-	<input type="checkbox"/>
Code Vessel Class	Code Length (Nominal)	Code Connection Size	Code Standard	Code Cartridge	Code Seal			
CE Standard	A 5" (125 mm) B 2 1/2" (65 mm)	B 1"	T Tri-Clamp	T 216	S Silicone			

Note: For accessories, i.e. gauges, please contact Parker domnick hunter - Process Division for full availability.

For additional features, Parker domnick hunter offer this housing as part of its Standard PLUS Range.
Please see HSL® datasheet for more information.

Parker domnick hunter has a continuous policy of product development and although the Company reserves the right to change specifications, it attempts to keep customers informed of any alterations. This publication is for general information only and customers are requested to contact our Process Filtration Sales Department for detailed information and advice on a products suitability for specific applications. All products are sold subject to the company's Standard conditions of sale.



Demi HSI Filter Housing

- in-line sanitary liquid

- In-line sanitary liquid housing
- High quality crevice free construction
- Sanitary body closure as standard



Specification

Materials of Construction

- Housing: 316L Stainless Steel
- Seals: Silicone FDA

Surface Finish

- Internal: Polished 0.4 µm Ra
- External: Polished 0.25 µm Ra

All finishes pickled & passivated.

Welding

All assembly welds are full penetration. All welds are crevice and undercut free.

Weld finish & detail drawings available upon request.

Certification

Supplied as standard with vessel inspection certificate.

Material Test Certification

EN10204 3.1 supplied upon request.

Design Code

Housings designed in accordance with the European Council Pressure Equipment Directive (PED) 97/23/EC and the UK Statutory Pressure Equipment Regulations (PER) 1999 N° 2001.

Design Basis

ASME VIII Division 1.

Working Condition PED 97/23/EC			Maximum Pressure	
Fluid Group	State	Temperature	01A	01B
Non Dangerous & Dangerous	Liquid / Gas	150 °C (302 °F)	10.00 barg (145.03 psig)	10.00 barg (145.03 psig)
PED Conformity Assessment Category			SEP	SEP
Volume (litres)			0.75	0.50

Physical Characteristics

Bowl Height	Dimensions (mm)		Typical Weight (Kg)
	'B'	'C'	
A Size 5" (125 mm)	207	130	1.0
B Size 2 1/2" (65 mm)	152	70	0.8

Dimensions are based on illustration shown (HSICE01AYT-T-S).
For accurate dimensions, please contact Parker domnick hunter.

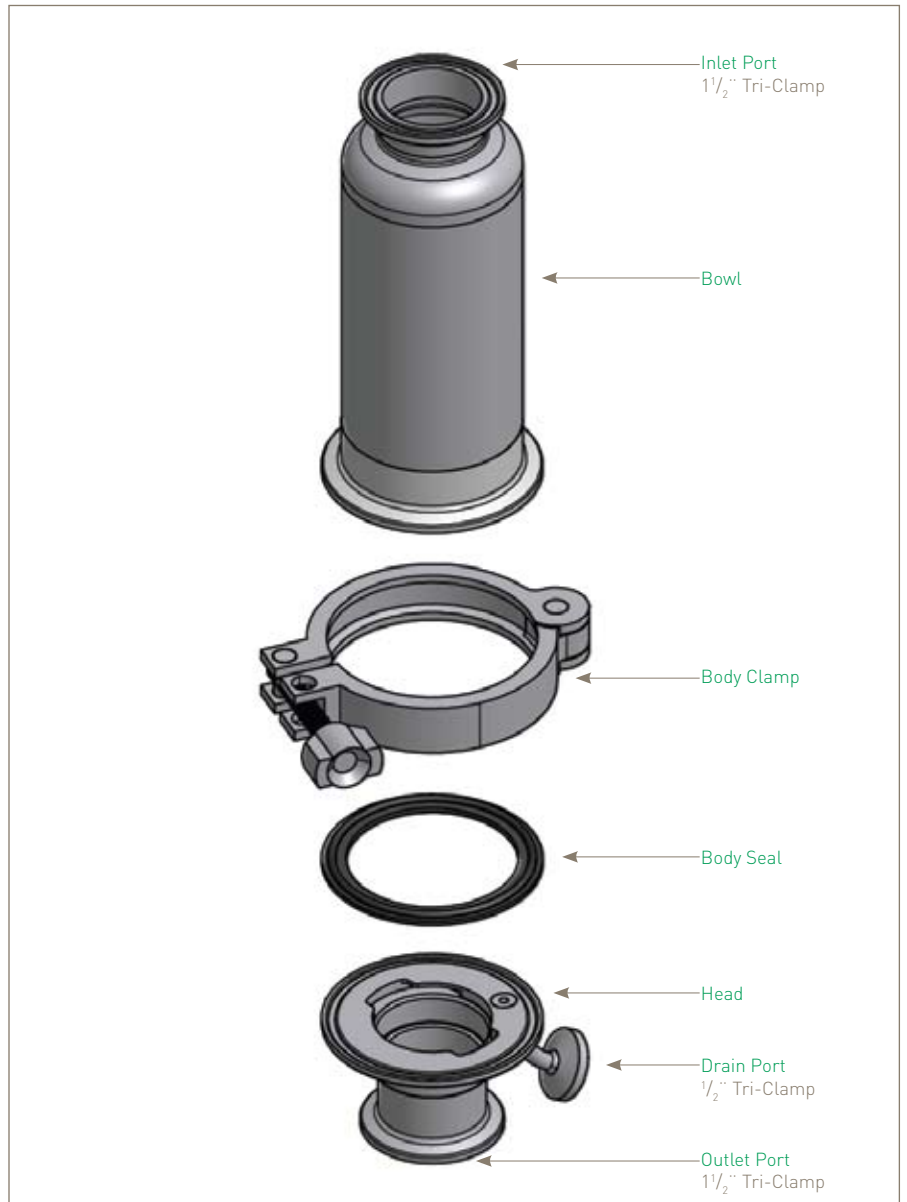
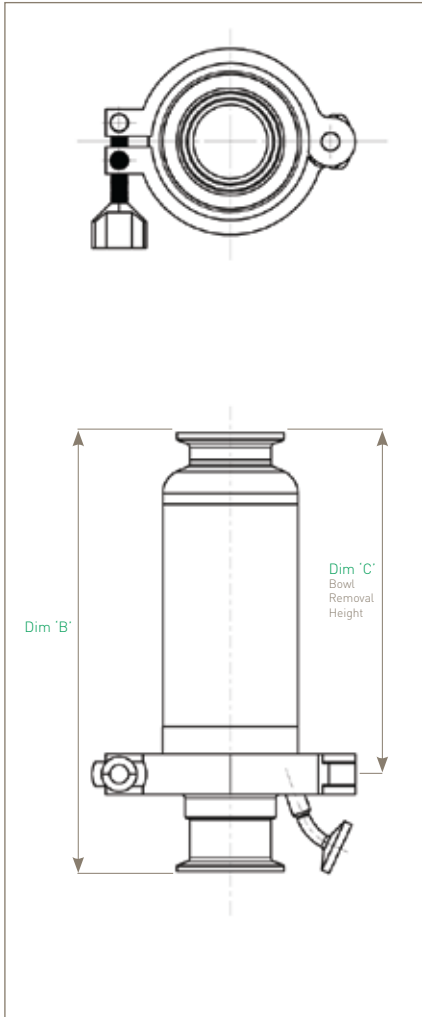

Ordering Information

Code Vessel Class	Code Length (Nominal)	Code Connection Size	Code Standard	Code Cartridge	Code Seal
CE Standard	A 5" (125 mm) B 2 1/2" (65 mm)	Y 1 1/2"	T Tri-Clamp	T 216	S Silicone

Note: For accessories, i.e. gauges, please contact Parker domnick hunter - Process Division for full availability.

For additional features, Parker domnick hunter offer this housing as part of its Standard PLUS Range.
Please see HSI® datasheet for more information.

Parker domnick hunter has a continuous policy of product development and although the Company reserves the right to change specifications, it attempts to keep customers informed of any alterations. This publication is for general information only and customers are requested to contact our Process Filtration Sales Department for detailed information and advice on a products suitability for specific applications. All products are sold subject to the company's Standard conditions of sale.



Demi HIF Filter Housing

- industrial air / liquid

- Industrial single element air / liquid housing
- 1/2" BSPP or NPT inlet / outlet standard connections
- Suitable replacement for plastic housings
- Suitable for Parker domnick hunter 'Z' style 116 'O' rings



Specification

Materials of Construction

- Housing: 316L Stainless Steel (Cast Head)
- Body Seal: EPDM FDA
- Vent / Drain Seal: PTFE FDA

Surface Finish

- Internal: Unpolished 1 µm Typical
 - External: Polished 0.8 µm Ra
- All finishes pickled & passivated.*

Welding

All assembly welds are full penetration. All welds are crevice and undercut free. *Weld finish & detail drawings available upon request.*

Certification

Supplied as standard with vessel inspection certificate.

Material Test Certification

EN10204 3.1 supplied upon request.

Design Code

Housings designed in accordance with the European Council Pressure Equipment Directive (PED) 97/23/EC and the UK Statutory Pressure Equipment Regulations (PER) 1999 N° 2001.

Design Basis

ASME VIII Division 1.

Working Condition PED 97/23/EC			Maximum Pressure	
Fluid Group	State	Temperature	01A	01B
Non Dangerous & Dangerous	Liquid / Gas	150 °C (302 °F)	10.00 barg (145.03 psig)	10.00 barg (145.03 psig)
PED Conformity Assessment Category			SEP	SEP
Volume (litres)			0.75	0.50

Physical Characteristics

Bowl Height	Dimensions (mm)			Typical Weight (Kg)
	'A'	'B'	'C'	
A Size 5" (125 mm)	75	226	130	1.5
B Size 2 1/2" (65 mm)	75	171	70	1.4

Dimensions are based on illustration shown (HIFCE01AAB-Z-E).
For accurate dimensions, please contact Parker domnick hunter.

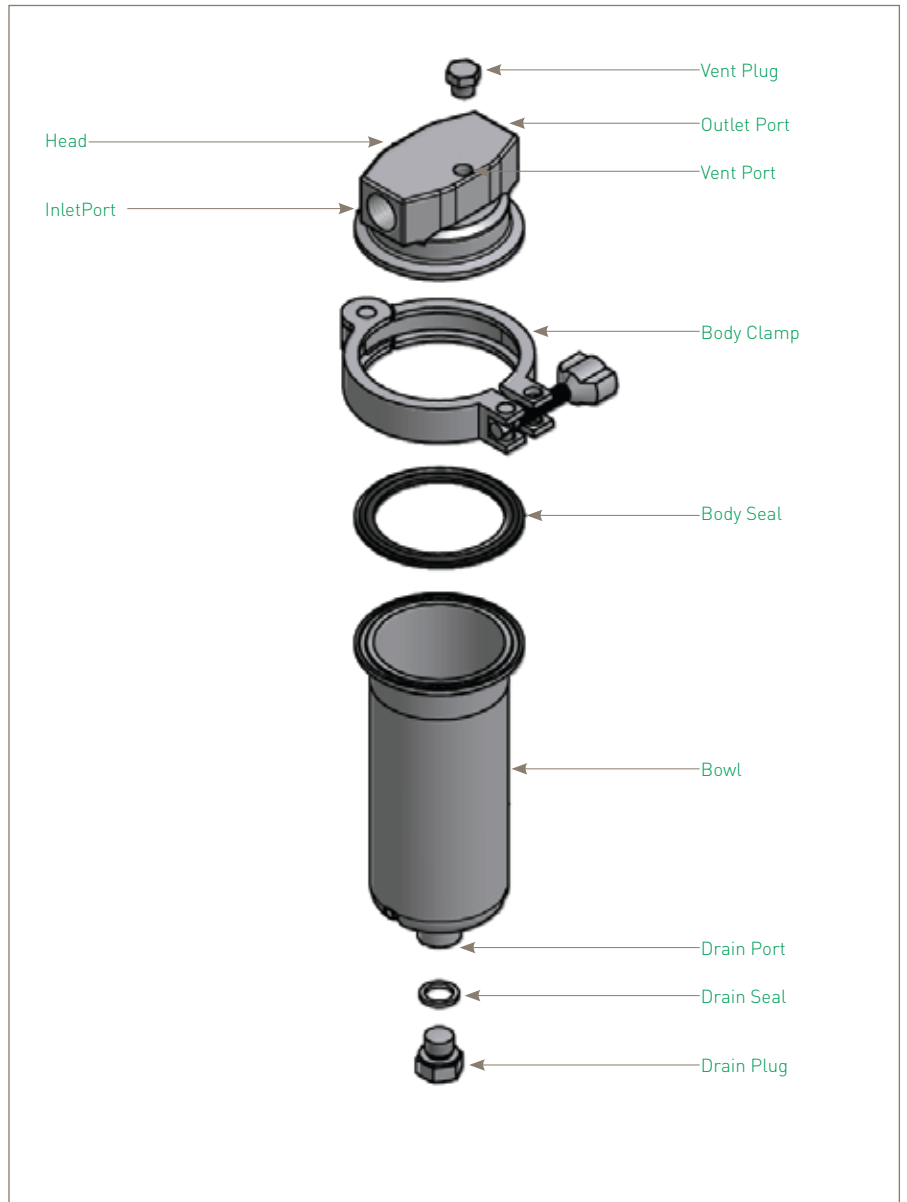
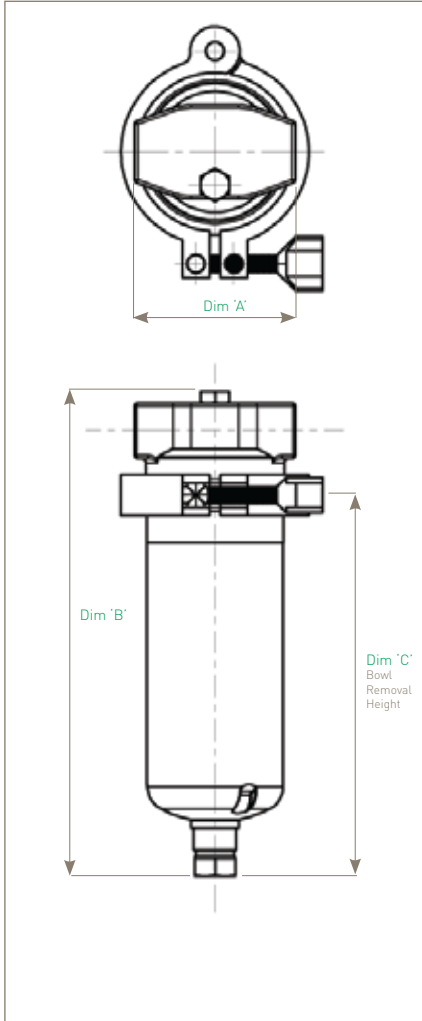

Ordering Information

HIF		01			-		-	
Code Vessel Class	Code Length (Nominal)	Code Connection Size	Code Standard	Code Cartridge	Code Seal			
CE Standard	A 5" (125 mm) B 2 1/2" (65 mm)	A 1/2"	B BSPP N NPT	Z 116	E EPDM			

Note: For accessories, i.e. gauges, please contact Parker domnick hunter - Process Division for full availability.

For additional features, Parker domnick hunter offer this housing as part of its Standard PLUS Range.
Please see HIF® datasheet for more information.

Parker domnick hunter has a continuous policy of product development and although the Company reserves the right to change specifications, it attempts to keep customers informed of any alterations. This publication is for general information only and customers are requested to contact our Process Filtration Sales Department for detailed information and advice on a products suitability for specific applications. All products are sold subject to the company's Standard conditions of sale.